

軸穴加工付スプロケットホイール

DKSチェーン歯車工業

204651

FBN50型軸穴加工付スプロケットホイール(新JISキー溝対応)

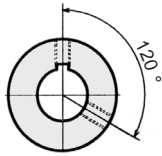
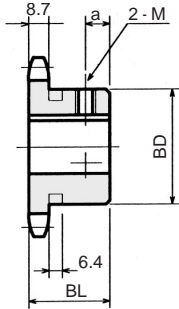

形番	穴 D	14	15	16	17	18	19	20	22	24	25
キー溝押ねじ	5×2.3 2-M6	5×2.3 2-M6	5×2.3 2-M6	5×2.3 2-M6	5×2.3 2-M6	6×2.8 2-M6	6×2.8 2-M6	6×2.8 2-M6	6×2.8 2-M6	8×3.3 2-M8	8×3.3 2-M8
FBN50B10			1,200	1,200	1,200	1,200	1,200	1,200	1,340	1,340	1,340
FBN50B11			1,250	1,250	1,250	1,250	1,250	1,250	1,430	1,430	1,430
FBN50B12			1,340	1,340	1,340	1,340	1,340	1,340	1,560	1,560	1,560
FBN50B13	1,430		1,430	1,430	1,430	1,430	1,430	1,430	1,560	1,560	1,560
FBN50B14	1,430	1,430	1,430	1,430	1,430	1,430	1,430	1,430	1,560	1,560	1,560
FBN50B15	1,430	1,430	1,430	1,430	1,430	1,430	1,430	1,430	1,560	1,560	1,560
FBN50B16	1,600	1,600	1,600	1,600	1,600	1,600	1,600	1,600	1,600	1,600	1,600
FBN50B17	1,600	1,600	1,600	1,600	1,600	1,600	1,600	1,600	1,690	1,690	1,690
FBN50B18	1,740	1,740	1,740	1,740	1,740	1,740	1,740	1,740	1,830	1,830	1,830
FBN50B19	1,780	1,780	1,780	1,780	1,780	1,780	1,780	1,780	1,780	1,870	1,870
FBN50B20	1,780	1,780	1,780	1,780	1,780	1,780	1,780	1,780	1,780	1,910	1,910
FBN50B21					1,840	1,840	1,840	1,840	1,840	1,980	1,980
FBN50B22					1,880	1,880	1,880	1,880	1,880	2,000	2,000
FBN50B23					2,050	2,050	2,050	2,050	2,050	2,050	2,050
FBN50B24					2,110	2,110	2,110	2,110	2,110	2,110	2,110
FBN50B25					2,160	2,160	2,160	2,160	2,160	2,160	2,160
FBN50B26										2,210	2,210
FBN50B27										2,350	2,350
FBN50B28										2,460	2,460
FBN50B29										2,540	
FBN50B30									2,650		2,650
FBN50B31											
FBN50B32											2,780
FBN50B33											
FBN50B34											3,020
FBN50B35											3,020

ボス径・ボス幅はB型と同じです。旧JISキー溝対応品、丸穴加工対応品も即納です。ご用命願います。

●形番の表示

FBN 50 B 20 - D20

FBN : 新JISキー溝対応
チェーンNo. ボス形状
歯数 軸穴径

●材質:S35C歯先高周波焼入

軸穴寸法表

軸穴径 D	キー溝 b × t ₂	タップ
14H7	5 × 2.3	2-M6
15H7	5 × 2.3	2-M6
16H7	5 × 2.3	2-M6
17H7	5 × 2.3	2-M6
18H7	6 × 2.8	2-M6
19H7	6 × 2.8	2-M6
20H7	6 × 2.8	2-M6
22H7	6 × 2.8	2-M6
24H7	8 × 3.3	2-M8
25H7	8 × 3.3	2-M8
28H7	8 × 3.3	2-M8
30H7	8 × 3.3	2-M8
32H7	10 × 3.3	2-M8
35H7	10 × 3.3	2-M8
38H7	10 × 3.3	2-M8
40H7	12 × 3.3	2-M8
42H7	12 × 3.3	2-M8
45H7	14 × 3.8	2-M10
50H7	14 × 3.8	2-M10

形番	穴 D	28	30	32	35	38	40	42	45	50
キー溝押ねじ	8×3.3 2-M8	8×3.3 2-M8	10×3.3 2-M8	10×3.3 2-M8	10×3.3 2-M8	12×3.3 2-M8	12×3.3 2-M8	12×3.3 2-M8	14×3.8 2-M10	14×3.8 2-M10
FBN50B10										
FBN50B11										
FBN50B12	1,560	1,560	1,560							
FBN50B13	1,560	1,560	1,560							
FBN50B14	1,560	1,560	1,560	1,560						
FBN50B15	1,560	1,560	1,560	1,560	1,560					
FBN50B16	1,600	1,600	1,600	1,600	1,690	1,690				
FBN50B17	1,690	1,690	1,690	1,780	1,780	1,780	1,780	1,780		
FBN50B18	1,830	1,830	1,960	1,960	1,960	1,960	1,960	1,960		
FBN50B19	1,870	1,870	2,000	2,000	2,000	2,000	2,000	2,000		
FBN50B20	1,910	1,910	1,910	1,910	1,910	1,910	2,220	2,220	2,220	2,220
FBN50B21	1,980	1,980	2,110	2,110	2,110	2,110	2,110	2,110	2,110	
FBN50B22	2,000	2,000	2,140	2,140	2,140	2,140	2,140	2,140	2,140	
FBN50B23	2,050	2,050	2,180	2,180	2,220	2,220	2,220	2,220	2,220	
FBN50B24	2,110	2,110	2,220	2,220	2,220	2,220	2,220	2,400	2,400	
FBN50B25	2,160	2,160	2,300	2,300	2,300	2,300	2,300	2,520	2,520	
FBN50B26	2,210	2,210	2,350	2,350	2,350	2,350	2,350		2,520	
FBN50B27	2,350	2,350	2,390	2,390	2,390	2,390	2,390		2,520	
FBN50B28	2,460	2,460	2,520	2,520	2,520	2,520	2,520	2,600	2,600	
FBN50B29		2,540								
FBN50B30	2,650	2,650	2,720	2,720	2,720	2,720	2,720		2,850	
FBN50B31										
FBN50B32	2,780	2,780	2,870	2,870	2,870	2,870			2,870	
FBN50B33				3,060						
FBN50B34	3,020	3,020	3,200	3,200	3,200	3,200			3,200	
FBN50B35	3,020	3,020	3,200	3,200	3,350	3,350			3,350	

ボス径・ボス幅はB型と同じです。旧JISキー溝対応品、丸穴加工対応品も即納です。ご用命願います。



空圧・油圧・真空

直動システム・関連

ロボット・FA

制御・検出・計測

駆動・回転

軸受・素材・機械

動力伝達・伝動

搬送・運搬

ポンプ・送風機・粉体

工場設備・環境