

NKS チルド車輪

(株)永瀬工場

313762



寸法図

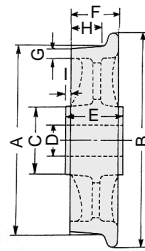

材質の種別

印：鑄鉄製

印：ダクタイルチルド製

●印：チルド鑄鉄製

下記の寸法は鑄放したままの寸法です。

片ツバ鑄放し車輪寸法および価格

単位：mm

| 車径A | 価格 | B | C | D | E | H | 耐荷重kg | 材質 |
|-------|--------|-----|-----|----|-----|----|-------|------|
| 75 | 1,620 | 100 | 52 | 0 | 55 | 30 | 250 | |
| 75A | 2,420 | 104 | 62 | 20 | 70 | 40 | 400 | |
| 75特A | 2,630 | 104 | 62 | 20 | 85 | 55 | 400 | |
| 100 | 2,520 | 125 | 60 | 0 | 53 | 30 | 250 | |
| 100A | 3,940 | 128 | 70 | 20 | 79 | 45 | 500 | |
| 100特A | 4,520 | 128 | 80 | 20 | 95 | 60 | 500 | |
| 127 | 4,040 | 160 | 65 | 23 | 62 | 40 | 200 | |
| 127A | 5,900 | 153 | 80 | 25 | 80 | 40 | 700 | |
| 127特A | 8,270 | 161 | 85 | 25 | 95 | 60 | 700 | ● |
| 153B | 4,870 | 180 | 66 | 23 | 76 | 45 | 250 | |
| 153A | 7,440 | 188 | 80 | 23 | 75 | 40 | 700 | ● |
| 153特A | 10,900 | 190 | 85 | 25 | 95 | 60 | 800 | ● |
| 178 | 6,670 | 208 | 75 | 30 | 76 | 40 | 300 | ● |
| 178A | 10,310 | 209 | 85 | 30 | 90 | 45 | 700 | ● |
| 178特A | 14,540 | 215 | 100 | 30 | 100 | 60 | 900 | ● |
| 200 | 6,270 | 220 | 73 | 30 | 62 | 35 | 300 | ●製陶用 |
| 203 | 7,270 | 232 | 78 | 30 | 80 | 40 | 300 | ● |
| 203A | 12,440 | 235 | 95 | 35 | 85 | 47 | 700 | ● |
| 203特A | 21,380 | 243 | 110 | 35 | 103 | 60 | 1,000 | ● |
| 230 | 8,730 | 258 | 75 | 30 | 78 | 45 | 300 | ● |
| 230A | 15,560 | 269 | 95 | 40 | 100 | 50 | 1,200 | ● |
| 230林道 | 15,560 | 268 | 110 | 40 | 90 | 50 | 700 | ● |
| 230特A | 22,730 | 270 | 115 | 40 | 116 | 70 | 1,500 | ● |
| 250 | 9,290 | 270 | 72 | 30 | 58 | 35 | 400 | ●製陶用 |

| 車径A | 価格 | B | C | D | E | H | 耐荷重kg | 材質 |
|---------|---------------|-----|-----|----|-----|----|--------|----|
| 255B | 9,730 | 280 | 75 | 30 | 78 | 45 | 300 | ● |
| 255A | 10,440 | 288 | 90 | 30 | 78 | 45 | 400 | ● |
| 255肉厚 | 11,810 | 288 | 95 | 30 | 78 | 45 | 500 | ● |
| 255巾広 | 15,880 | 293 | 100 | 30 | 95 | 55 | 750 | ● |
| 255特B | 19,080 | 295 | 100 | 40 | 100 | 55 | 1,200 | ● |
| 250特A | 22,710 | 290 | 120 | 40 | 110 | 55 | 1,300 | ● |
| 255巾広特A | 22,270 | 297 | 120 | 40 | 121 | 75 | 1,500 | ● |
| 305B | 13,000 | 333 | 82 | 35 | 85 | 45 | 500 | ● |
| 305A | 14,540 | 333 | 95 | 40 | 87 | 45 | 700 | ● |
| 305巾広 | 16,370 | 340 | 100 | 30 | 97 | 55 | 900 | ● |
| 305丸窓B | 24,150/30,540 | 340 | 125 | 40 | 97 | 55 | 1,750 | ● |
| 305丸窓A | 38,170/47,500 | 352 | 150 | 50 | 130 | 75 | 3,500 | ● |
| 305丸窓A大 | 44,630/55,400 | 352 | 170 | 65 | 125 | 75 | 3,500 | ● |
| 355B | 25,440 | 400 | 110 | 40 | 110 | 65 | 1,000 | ● |
| 355 | 32,310 | 400 | 105 | 38 | 120 | 75 | 1,000 | ● |
| 355A | 36,350 | 400 | 140 | 40 | 119 | 65 | 3,000 | ● |
| 355丸窓A | 56,350/70,120 | 406 | 160 | 50 | 150 | 75 | 4,000 | ● |
| 355丸窓A大 | 61,790/76,920 | 406 | 180 | 70 | 150 | 80 | 4,000 | ● |
| 400丸窓B | 84,810 | 454 | 160 | 60 | 165 | 80 | 3,500 | |
| 400丸窓A | 101,770 | 454 | 180 | 60 | 165 | 80 | 5,000 | |
| 450丸窓B | 99,560 | 504 | 165 | 70 | 164 | 80 | 4,000 | |
| 450丸窓A | 122,170 | 504 | 200 | 80 | 164 | 80 | 7,500 | |
| 500丸窓B | 123,170 | 554 | 180 | 70 | 165 | 80 | 5,000 | |
| 500丸窓A | 155,880 | 554 | 240 | 90 | 172 | 80 | 10,000 | |

寸法図

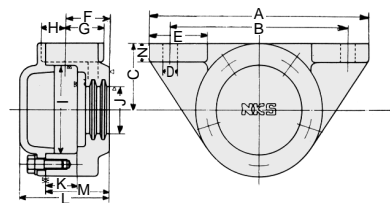

ボールベアリングケース(肉厚強力型)寸法および価格

単位：mm

| ベアリングNo | 価格 | A | B | C | D | F | I | L | M |
|---------|--------|-----|-----|----|----|----|-----|-----|----|
| 1205 | 5,370 | 160 | 125 | 43 | 14 | 33 | 52 | 62 | 46 |
| 1206 | 6,130 | 180 | 140 | 50 | 14 | 38 | 62 | 67 | 50 |
| 1207 | 7,170 | 180 | 140 | 52 | 14 | 38 | 72 | 70 | 50 |
| 1307 | 10,980 | 210 | 170 | 61 | 14 | 47 | 80 | 91 | 64 |
| 1308 | 13,020 | 210 | 170 | 67 | 14 | 50 | 90 | 97 | 64 |
| 1309 | 16,370 | 270 | 210 | 75 | 17 | 52 | 100 | 99 | 72 |
| 1310 | 19,670 | 270 | 210 | 82 | 17 | 57 | 110 | 103 | 77 |
| 1311 | 22,500 | 290 | 230 | 81 | 17 | 58 | 120 | 120 | 82 |

| ベアリングNo | 価格 | A | B | C | D | F | I | L | M |
|---------|---------|-----|-----|-----|----|----|-----|-----|-----|
| 1312 | 27,080 | 290 | 230 | 92 | 17 | 62 | 130 | 119 | 81 |
| 1313 | 35,770 | 320 | 260 | 97 | 21 | 63 | 140 | 113 | 86 |
| 1314 | 44,960 | 320 | 260 | 106 | 21 | 69 | 150 | 125 | 95 |
| 1315 | 53,650 | 350 | 285 | 110 | 21 | 70 | 160 | 125 | 100 |
| 1316 | 65,920 | 400 | 320 | 135 | 24 | 75 | 170 | 140 | 102 |
| 22217 | 61,540 | 380 | 290 | 120 | 28 | 74 | 150 | 120 | 90 |
| 22220 | 90,380 | 430 | 330 | 140 | 28 | 80 | 180 | 130 | 100 |
| 22224 | 159,620 | 520 | 400 | 162 | 28 | 97 | 215 | 165 | 132 |



下駄メタル



油壺



砲金メタル

油壺砲金メタル・下駄メタル

| No | メタル径 | 油壺砲金メタル付(1台分) | 下駄メタル1個 |
|----|-------------------------------------|---------------|---------|
| 1 | 33mm 1 ⁵ / ₁₆ | 御見積 | 御見積 |
| 2 | 38 1 ¹ / ₂ | 御見積 | 御見積 |
| 3 | 44 1 ³ / ₄ | 御見積 | 御見積 |